

	1	2	3	4	5	6	7	8	9	10	11	12
	d	b	c	d	e	f	g	h	i	j		
TYPE	SPAN (mm)	RISE (mm)	END AREA (m ²)	CROWN ANGLE	CROWN RADIUS	HAUNCH ANGLE	HAUNCH RADIUS	SIDE ANGLE	SIDE LENGTH	TOTAL S		
BC-42	9810	2105	16.9	4.353	114.30	64.3	1016	3.9	419	29		
BC-43	9865	2510	20.9	4.353	114.30	64.3	1016	3.9	825	31		
BC-44	9920	2920	24.9	4.353	114.30	64.3	1016	3.9	1232	33		
BC-45	10460	2285	19.4	4.758	114.30	64.3	1016	1.9	419	31		
BC-46	10485	2690	23.7	4.758	114.30	64.3	1016	1.9	825	33		
BC-47	10515	3100	28.0	4.758	114.30	64.3	1016	1.9	1232	35		
BC-48	10895	2355	20.6	5.009	114.30	61.6	1016	3.3	419	32		
BC-49	10940	2760	25.0	5.009	114.30	61.6	1016	3.3	825	34		
BC-50	10990	3165	29.5	5.009	114.30	61.6	1016	3.3	1232	36		
BC-51	11645	2530	23.31	5.467	114.30	58.96	1016	3.71	419	34		
BC-52	11700	2935	28.04	5.467	114.30	58.96	1016	3.71	825	36		
BC-53	11750	3345	32.81	5.467	114.30	58.96	1016	3.71	1232	38		
BC-54	12270	2745	26.46	5.872	114.30	58.96	1016	1.68	419	36		
BC-55	12290	3150	31.45	5.872	114.30	58.96	1016	1.68	825	38		
BC-56	12315	3555	36.45	5.872	114.30	58.96	1016	1.68	1232	40		
BC-57	12255	3205	31.98	5.603	115.00	57.44	1250	4.54	855	38		
BC-58	12300	3350	34.14	5.345	120.00	59.49	1250	3.79	1038	39		
BC-59	12400	3370	34.22	5.680	115.00	56.97	1250	4.63	991	39		
BC-60	12435	3575	36.73	5.680	115.00	56.97	1250	4.63	1195	40		
BC-61	12500	3980	41.78	5.680	115.00	56.97	1250	4.63	1601	42		
BC-62	12505	3400	35.77	4.723	135.00	61.71	1250	4.68	1228	40		
BC-63	12605	3525	36.40	5.790	115.00	56.04	1250	5.01	1105	40		
BC-64	13090	3925	43.08	5.122	130.00	56.77	1250	7.62	1702	43		
BC-65	13140	3680	40.45	5.200	130.00	56.77	1250	7.23	1409	42		
BC-66	13300	3880	44.19	4.498	150.00	62.63	1250	4.88	1696	44		
BC-67	13405	3445	38.37	4.580	150.00	62.02	1250	5.08	1196	42		
BC-68	13460	3505	38.77	5.514	130.00	60.00	1250	2.43	977	42		
BC-69	13475	3820	43.81	4.580	150.00	62.02	1250	5.08	1603	44		
BC-70	13490	3915	44.24	5.514	130.00	60.00	1250	2.43	1383	44		
BC-71	13500	4095	46.91	5.234	135.00	60.43	1250	3.41	1668	45		
BC-72	13700	3920	45.81	4.725	150.00	63.09	1250	3.28	1590	45		
BC-73	13930	3690	42.81	5.009	145.00	60.13	1250	4.83	1301	44		
BC-74	13995	4090	48.47	5.009	145.00	60.13	1250	4.83	1708	46		
BC-75	14395	3765	46.19	4.368	170.00	64.59	1250	3.57	1466	46		
BC-76	14620	3890	48.51	4.459	170.00	64.43	1250	3.28	1538	47		
BC-77	14935	3495	44.04	4.165	185.00	65.00	1250	4.17	1214	46		
BC-78	14995	3900	50.11	4.165	185.00	65.00	1250	4.17	1621	48		
BC-79	15750	3860	51.10	4.423	185.00	62.59	1250	5.30	1461	49		
BC-80	15990	3980	53.52	4.513	185.00	62.53	1250	4.90	1519	50		
BC-81	16500	4185	58.16	4.731	185.00	63.39	1250	2.96	1553	52		
BC-82	17000	4440	63.54	4.900	185.00	62.21	1250	3.28	1712	54		

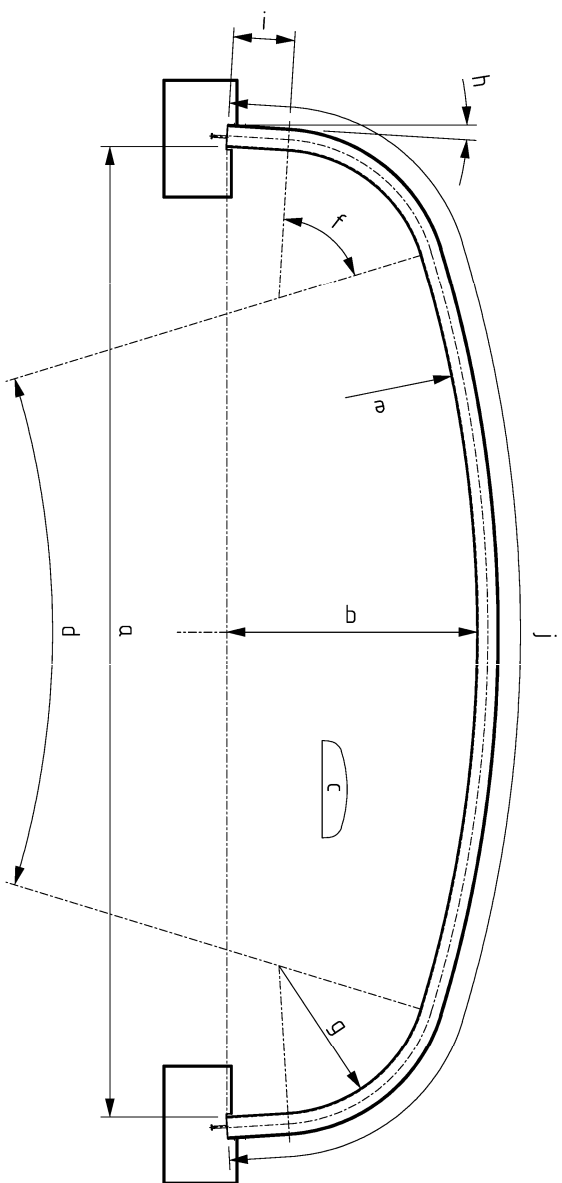

- NOTES:**
1. ALL DIMENSIONS ARE TO INSIDE CREST OF CORRUGATION.
 2. 114mm EDGE DISTANCE OF STEEL IS INCLUDED INSIDE ARC LENGTH AND ANGLE.
 3. 'S' = 406.4mm

REV#	DATE	REVISION DESCRIPTION	DRAWN	DRAFT	CHK	DES	ENG	LEAD	ENG	DRAWING No.	REFERENCE DRAWINGS
0	20 JAN 18	INITIAL ISSUE	BF	BF							
1											
2											
3											
4											

A3 SCALE N.T.S.

roundel
CIVIL PRODUCTS PTY LTD

Flynn Central Business Park
9 Weirman Street
Neserakup
Western Australia
© Copyright
of Roundel Civil Products. It shall not be
copied without permission.

BCMS BOX CULVERTS
CORRUGATION B381 x 140
STANDARD GEOMETRY RANGE
TYPE BC-42 TO BC-82

DWG No. RDL-STD-BC-002

REV 0